

# Welcome to the Acropolis Museum

## Café & Restaurant

- Café on the ground floor, behind the Shop.
- Restaurant on the 2nd floor.
- Last orders accepted 30 minutes prior to the Museum's closing time.
- Every Friday and Saturday evening, the restaurant remains open until midnight.

## Shops

- Souvenirs and gifts, on the ground floor.
- Bookshop, on the 2nd floor.
- Shops close 15 minutes prior to the Museum's closing time.

## Families





- Children's strollers for loan, available at the cloakroom, on the ground floor.
- Parent's room for personal care of babies and small children, on the 1st floor.
- Kids Corner on the 2nd floor, next to the restaurant.
- Family backpacks and family trails, at no charge, available at the Information Desk.

## Adults

- Free audio guide. QR code available at the Museum ground floor and at the bottom of this page.
- Reservations for Museum thematic presentations: [events.theacropolismuseum.gr](http://events.theacropolismuseum.gr)

## Please

For the safety and security of the exhibits

-  Leave large purses and bags at the cloakroom.
-  Do not touch the exhibits.
-  Do not bring food or drinks into the exhibition galleries.
-  No photography or videos in the Archaic Acropolis Gallery, for the protection of the sculptures.
-  Set your mobile telephones to silent and avoid their use while touring the exhibition galleries.

## Audio guide



## Accessibility

- The archaeological excavation is accessible from the Museum's entrance courtyard.
- Ramps for wheelchair and stroller access at the Museum's entrances.
- Elevator access and WCs for disabled people on all levels.
- Wheelchairs for loan: inquire at the Information Desk on the ground floor.
- Short guide to the Museum in Braille available from the Information Desk.
- Guide dogs accompanying people with disabilities are welcome.

## Information

Inquire at the Information Desk on the ground floor next to the ticket desks.

Acropolis Museum  
Dionysiou Areopagitou 15  
Athens 11742  
Tel.: 210 9000900  
[www.theacropolismuseum.gr](http://www.theacropolismuseum.gr)



ACROPOLIS MUSEUM



Photo: West frieze of the Parthenon, Block X, two young knights enthusiastically galloping

Discover 24 of the Museum's most beloved exhibits using this guide map, in about 2 hours.

map of the acropolis museum

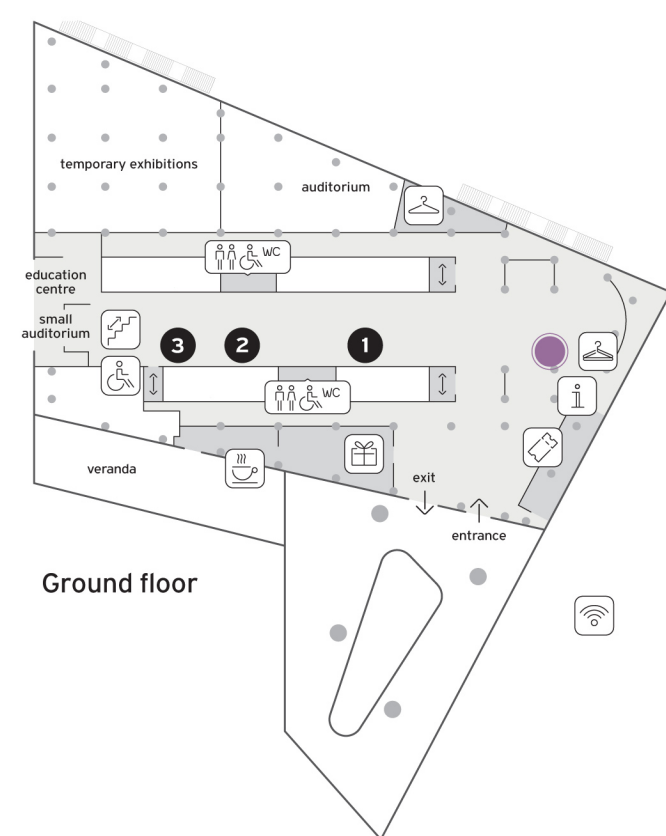
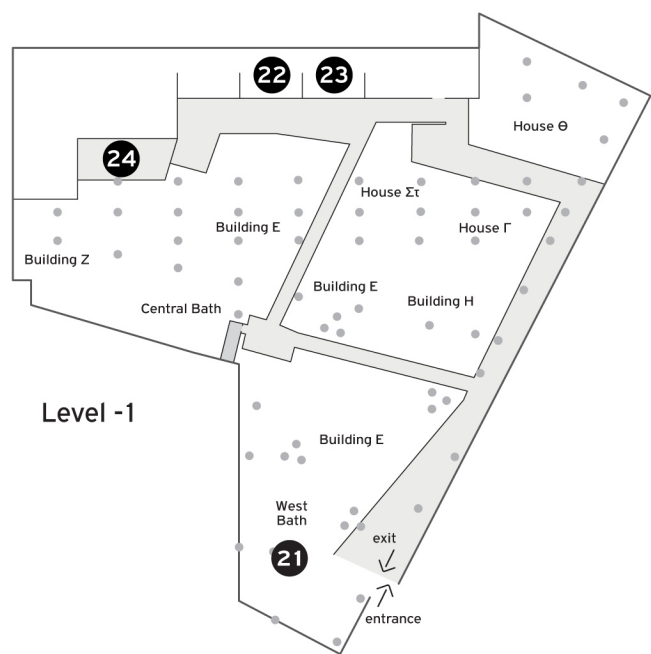

Excavation Museum



21. View of the archaeological excavation site beneath the Museum  
22. View of the Excavation Museum



23. Vessel in the form of a child's head  
24. Bust of philosopher Aristotle

Acropolis Slopes



1. Black-figure loutrophoros  
2. Pillar with a dedication to Asklepios



3. Papposilenos

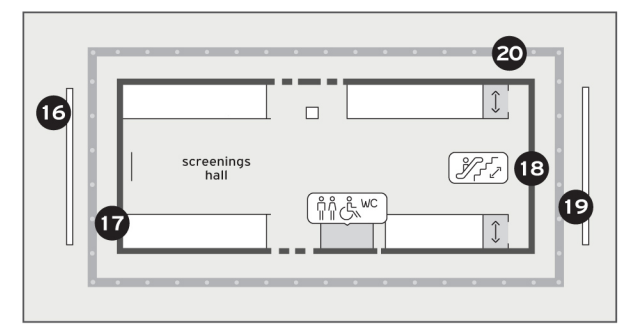
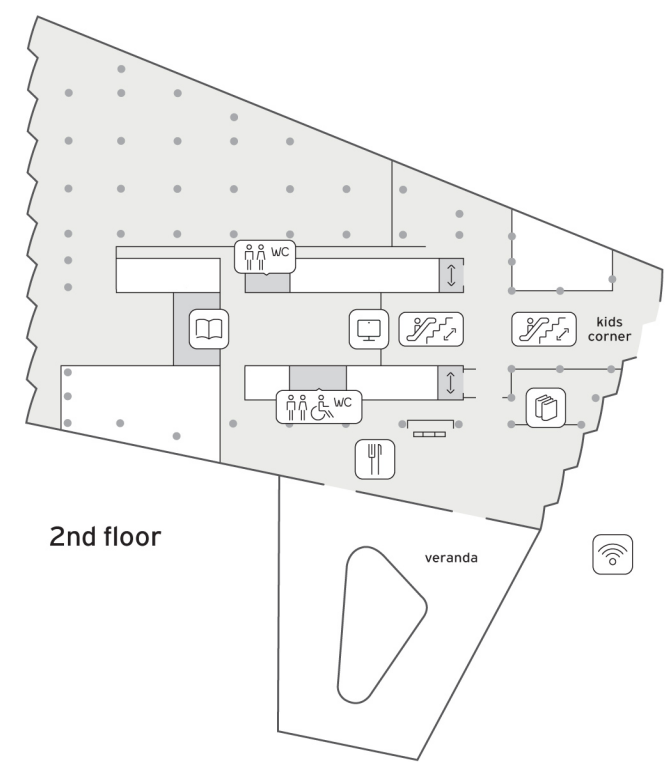
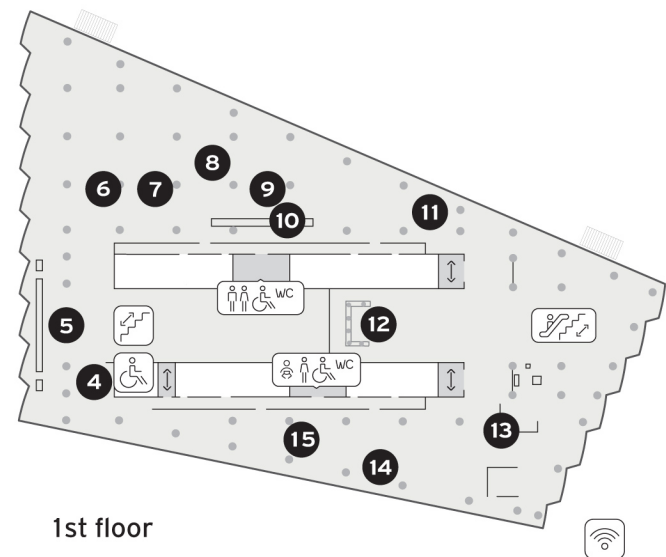

Acropolis 13th - 7th cents. BC



4. Bronze disk with Gorgon

Archaic Acropolis

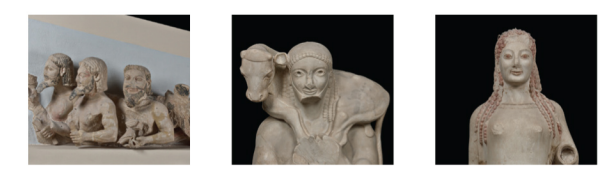

5. Pediment of the Hekatompedon  
6. Calf-Bearer  
7. Peplos Kore



8. Rampin Rider  
9. Antenor Kore  
10. Gigantomachy Pediment



11. Kritios boy

Erechtheion

Athena Nike



12. The Karyatids, Erechtheion

13. The winged goddess Nike

5th cent. BC - 7th cent. AD



14. Decrees honouring the Samians

15. Portrait of Alexander the Great

Parthenon



16. East Pediment  
17. East Frieze, Block VI  
18. West Frieze, Block VIII



19. West Pediment

20. South Metope 1

Legend of icons:

- exhibits
- you are here
- tickets
- information desk
- shop
- café
- elevator
- stairs
- escalator
- toilets
- parents' room
- cloakroom
- groups' cloakroom
- men's toilets
- women's toilet
- wheelchair access
- reading lounge
- wi-fi
- restaurant
- bookshop
- multimedia center